

Soils Map

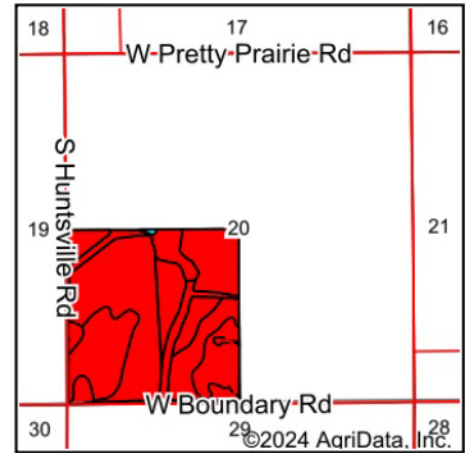
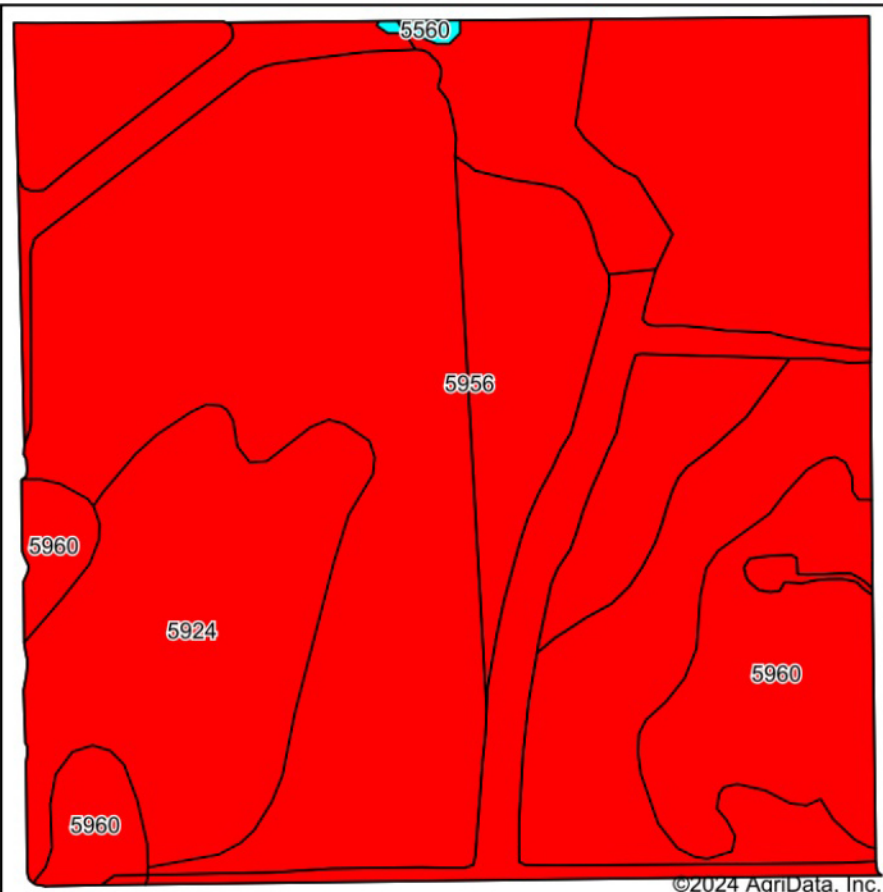

State: **Kansas**
 County: **Reno**
 Location: **20-26S-9W**
 Township: **Bell**
 Acres: **158.37**
 Date: **12/23/2024**

BigIron
 REALTY

Maps Provided By:



Soils data provided by USDA and NRCS.

©2024 AgriData, Inc.

Area Symbol: KS155, Soil Area Version: 21

Code	Soil Description	Acres	Percent of field	Non-Irr Class Legend	Non-Irr Class *c	Irr Class *c	*n NCCPI Soybeans
5956	Shellabarger sandy loam, 1 to 3 percent slopes	118.54	74.9%		Ile	Ile	51
5924	Ost-Clark loams, 1 to 3 percent slopes	21.76	13.7%		Ile	Ile	68
5960	Shellabarger-Nalim complex, 1 to 3 percent slopes	17.79	11.2%		Ile	Ile	57
5560	Kanza-Ninnescah sandy loams, frequently flooded	0.28	0.2%		Vw		28
Weighted Average					2.01	*-	*n 54