

Soils Map

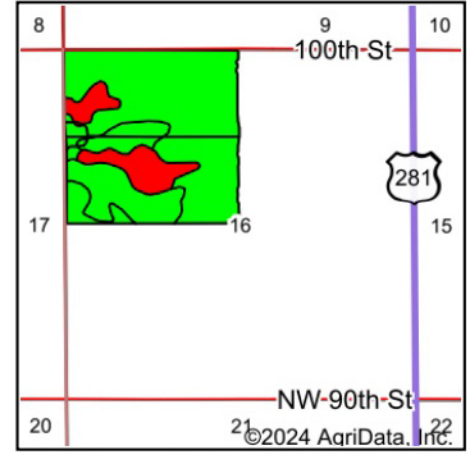
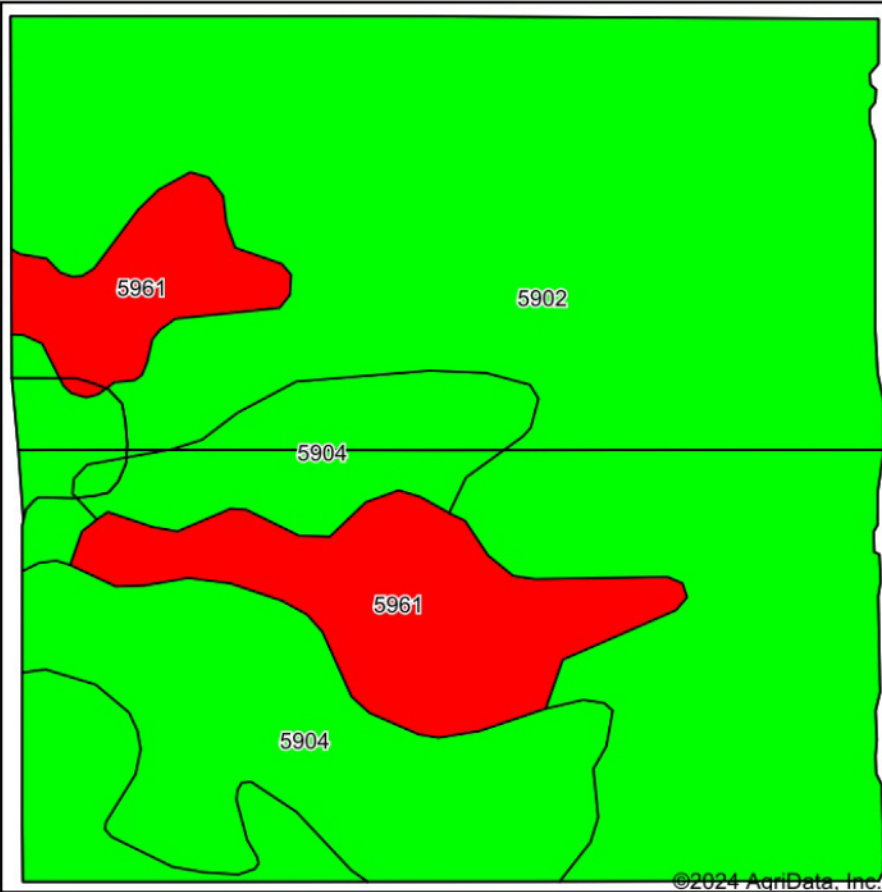

State: **Kansas**
 County: **Pratt**
 Location: **16-26S-13W**
 Township: **Township No. 7**
 Acres: **157.91**
 Date: **8/15/2024**

BigIron
 REALTY

Maps Provided By:



© AgriData, Inc. 2023

www.AgriDataInc.com



Soils data provided by USDA and NRCS.

©2024 AgriData, Inc.

Area Symbol: KS151, Soil Area Version: 21

Code	Soil Description	Acres	Percent of field	Non-Irr Class Legend	Non-Irr Class *c	Irr Class *c	*n NCCPI Soybeans
5902	Hayes fine sandy loam, 1 to 5 percent slopes	104.91	66.4%		IIIe	IIIe	50
5904	Hayes loamy fine sand, 5 to 10 percent slopes	32.30	20.5%		IIIe	Ile	43
5961	Solvay loamy fine sand, 0 to 2 percent slopes	20.70	13.1%		Ile	Ile	50
Weighted Average					2.87	2.66	*n 48.6