

Soils Map

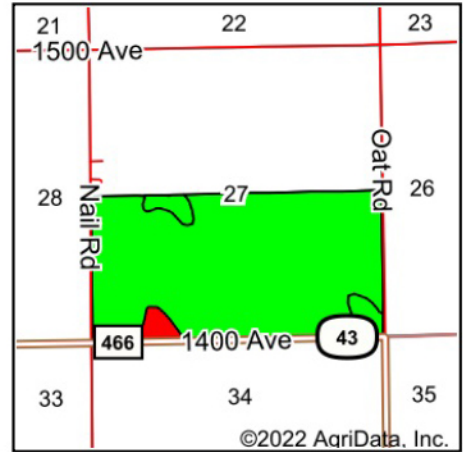

State: **Kansas**
 County: **Dickinson**
 Location: **27-14S-3E**
 Township: **Logan**
 Acres: **315.31**
 Date: **6/27/2022**

BigIron
 REALTY

Maps Provided By:



© AgriData, Inc. 2021

www.AgriDataInc.com



©2022 AgriData, Inc.

Soils data provided by USDA and NRCS.

Area Symbol: KS041, Soil Area Version: 20

Code	Soil Description	Acres	Percent of field	Non-Irr Class Legend	Non-Irr Class *c	Irr Class *c	*n NCCPI Soybeans
4671	Irwin silty clay loam, 1 to 3 percent slopes	293.51	93.1%		IIIs	IIIs	56
4673	Irwin silty clay loam, 3 to 7 percent slopes	14.46	4.6%		IVe	IVe	57
3827	Crete silty clay loam, 0 to 1 percent slopes	7.34	2.3%		IIs	IIs	66
Weighted Average					3.02	3.02	*n 56.3