

Soils Map

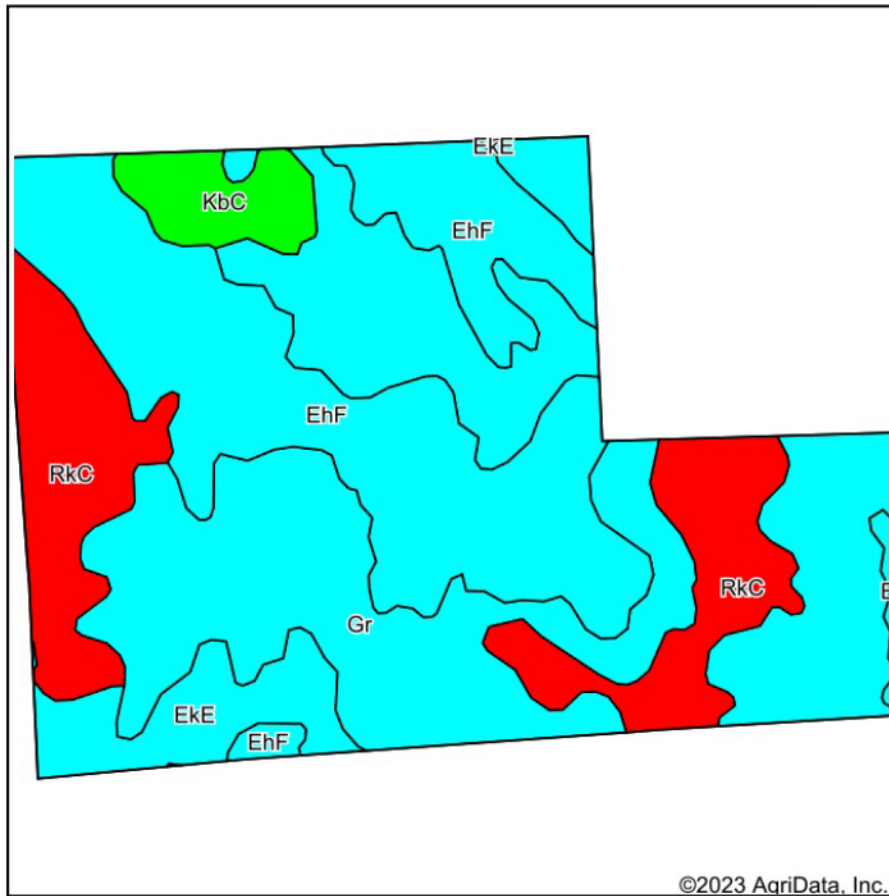

Soils data provided by USDA and NRCS.

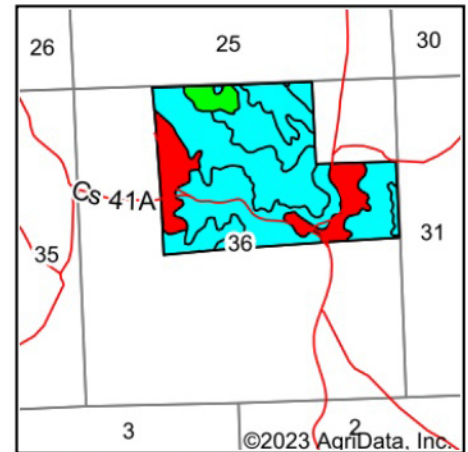

State: **South Dakota**
 County: **Jackson**
 Location: **36-41N-40W**
 Township: **Southwest Jackson**
 Acres: **200**
 Date: **7/11/2023**

BigIron
 REALTY

Maps Provided By:



© AgriData, Inc. 2023

www.AgrIDataInc.com



Area Symbol: SD610, Soil Area Version: 8

Code	Soil Description	Acres	Percent of field	Non-Irr Class Legend	Non-Irr Class *c	Productivity Index	Corn Irrigated Bu	Winter wheat Bu	Winter wheat Irrigated Bu	*n NCCPI Soybeans
Gr	Nihill gravelly loam, 3 to 40 percent slopes	85.13	42.6%		Vls	6				15
EhF	Epping-Kadoka silt loam, 9 to 40 percent slopes	61.81	30.9%		Vlle	27				20
RkC	Richfield-Keith silt loams, 3 to 9 percent slopes	32.70	16.4%		Ile	74	135	31	45	44
EkE	Epping-Kadoka silt loams, 9 to 18 percent slopes	11.23	5.6%		Vlle	31				24
KbC	Kadoka-Epping silt loams, 3 to 9 percent slopes	7.21	3.6%		Ille	58				30
Er	Epping-Badland complex, 3 to 60 percent slopes	1.92	1.0%		Vlle	8				11
Weighted Average					5.61	26.9	22.1	5.1	7.4	*n 22.3