

Soils Map

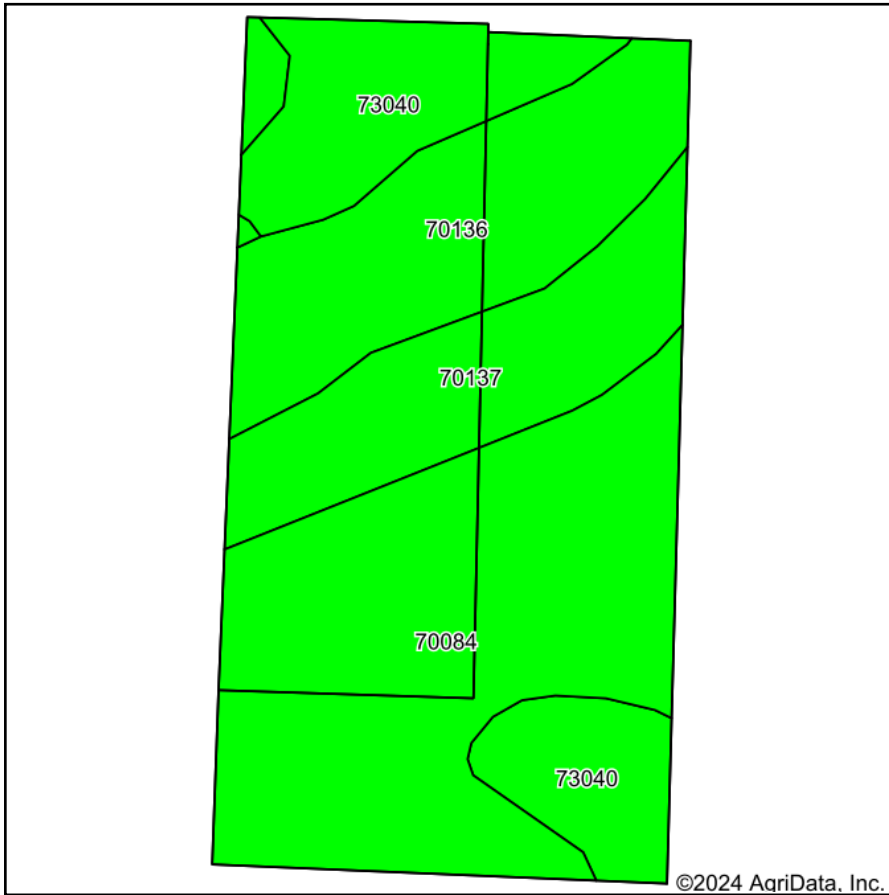

Soils data provided by USDA and NRCS.

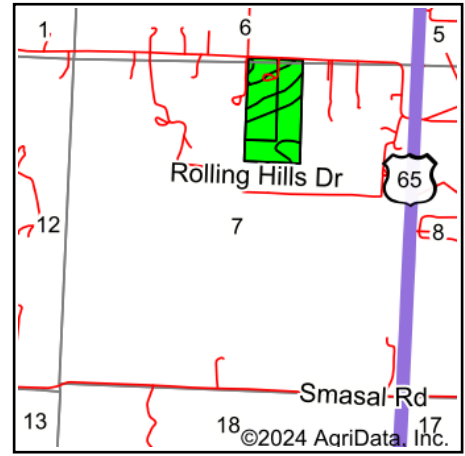

State: **Missouri**
 County: **Pettis**
 Location: **7-44N-21W**
 Township: **Flat Creek**
 Acres: **33.19**
 Date: **8/20/2024**



Area Symbol: MO159, Soil Area Version: 26

Code	Soil Description	Acres	Percent of field	Non-Irr Class Legend	Non-Irr Class *c	Corn Bu	Soybeans Bu	*n NCCPI Overall	*n NCCPI Corn	*n NCCPI Soybeans
70084	Eldon gravelly silt loam, 3 to 8 percent slopes	14.56	43.9%		IIIe			64	64	46
70136	Paintbrush silt loam, 2 to 5 percent slopes	6.97	21.0%		IIIe			55	55	39
73040	Maplewood silt loam, 2 to 5 percent slopes, eroded	6.17	18.6%		Ile	2	1	59	53	45
70137	Paintbrush silt loam, 2 to 5 percent slopes, eroded	5.49	16.5%		IIIe			48	48	28
Weighted Average					2.81	0.4	0.2	*n 58.5	*n 57.4	*n 41.4

*n: The aggregation method is "Weighted Average using all components"

*c: Using Capabilities Class Dominant Condition Aggregation Method