

Soils Map

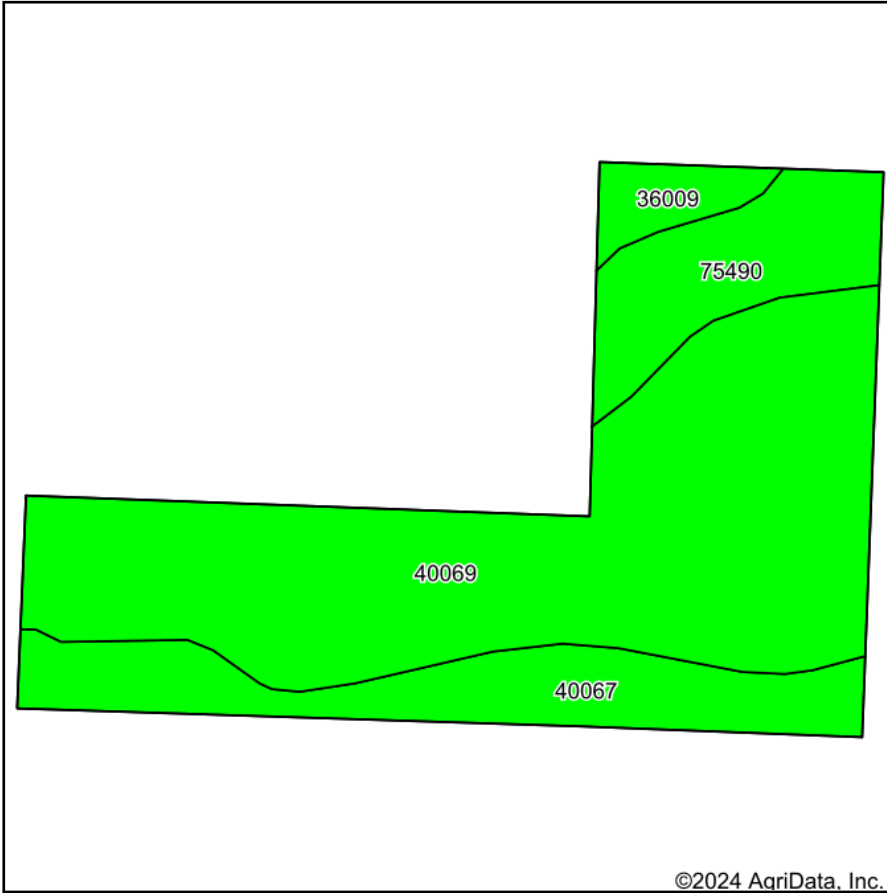

Soils data provided by USDA and NRCS.

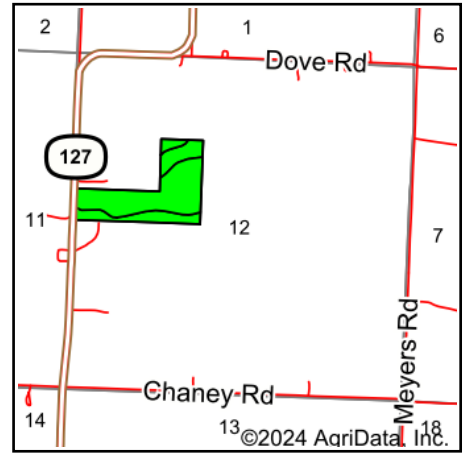

State: **Missouri**
 County: **Pettis**
 Location: **12-44N-23W**
 Township: **Green Ridge**
 Acres: **34.96**
 Date: **2/26/2024**

BigIron
 REALTY

Maps Provided By:

 CUSTOMIZED ONLINE MAPPING
 © AgriData, Inc. 2023 www.AgriDataInc.com



Area Symbol: MO159, Soil Area Version: 26

Code	Soil Description	Acres	Percent of field	Non-Irr Class Legend	Non-Irr Class *c	*n NCCPI Overall	*n NCCPI Corn	*n NCCPI Soybeans
40069	Hartwell silt loam, foot slopes, 0 to 1 percent slopes	22.52	64.4%		Ilw	89	89	75
40067	Hartwell silt loam, 1 to 3 percent slopes, eroded	6.65	19.0%		Ille	61	57	56
75490	Lamine silt loam, 0 to 2 percent slopes, occasionally flooded	4.48	12.8%		Ilw	65	64	50
36009	Colo silt loam, 0 to 2 percent slopes, frequently flooded	1.31	3.7%		IVw	21	8	3
Weighted Average					2.27	*n 78.1	*n 76.7	*n 65.5

*n: The aggregation method is "Weighted Average using all components"

*c: Using Capabilities Class Dominant Condition Aggregation Method