

Soils Map

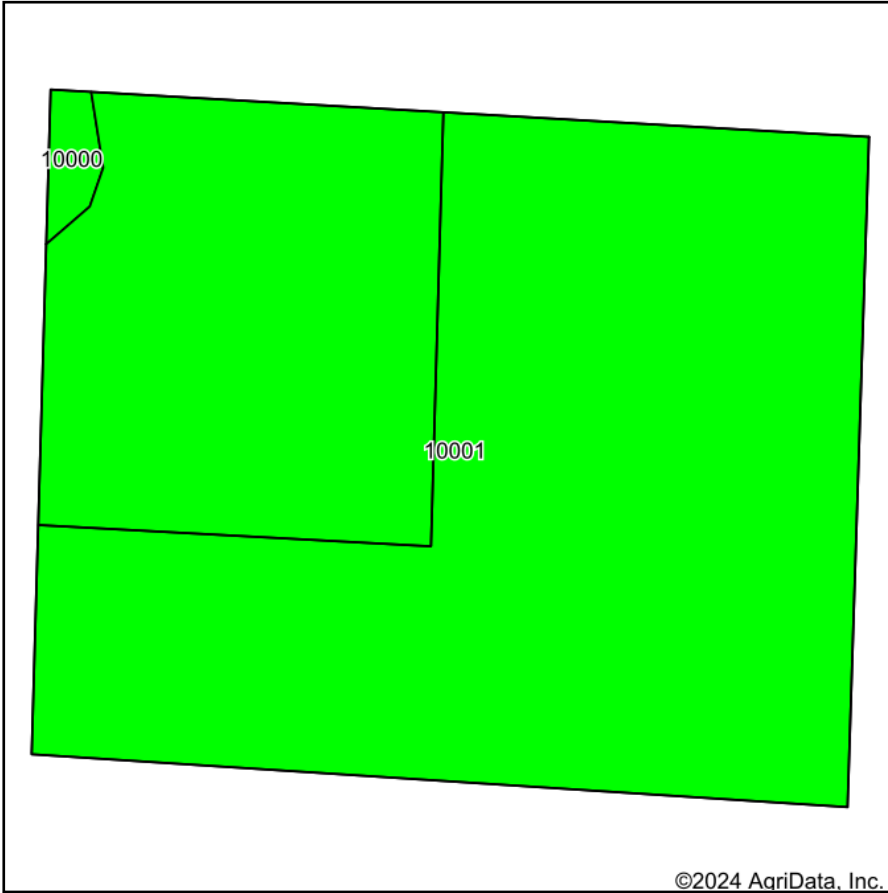

Soils data provided by USDA and NRCS.

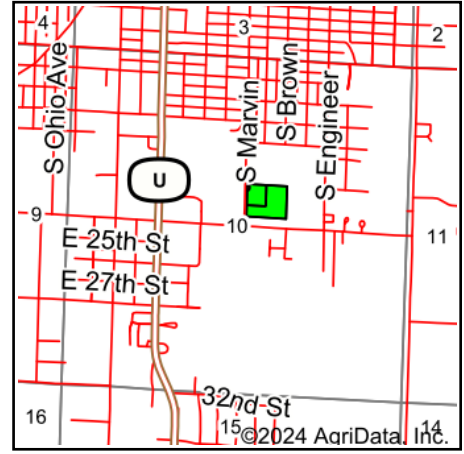

State: **Missouri**
 County: **Pettis**
 Location: **10-45N-21W**
 Township: **Sedalia**
 Acres: **7.29**
 Date: **1/31/2024**



Maps Provided By:



© AgriData, Inc. 2023

www.AgriDataInc.com



Area Symbol: MO159, Soil Area Version: 26

Code	Soil Description	Acres	Percent of field	Non-Irr Class Legend	Non-Irr Class *c	*n NCCPI Overall	*n NCCPI Corn	*n NCCPI Soybeans
10001	Arisburg silt loam, 2 to 5 percent slopes, eroded	7.21	98.9%		Ile	73	73	59
10000	Arisburg silt loam, 1 to 5 percent slopes	0.08	1.1%		Ile	81	81	65
Weighted Average					2.00	*n 73.1	*n 73.1	*n 59.1

*n: The aggregation method is "Weighted Average using all components"

*c: Using Capabilities Class Dominant Condition Aggregation Method