

Soils Map

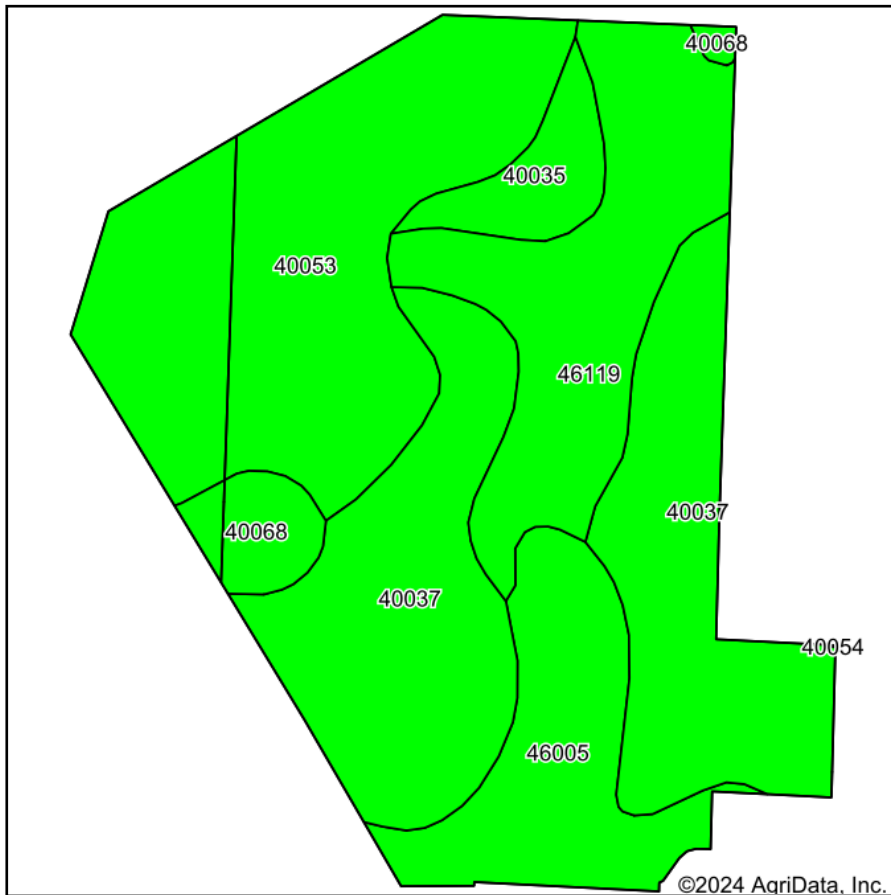

Soils data provided by USDA and NRCS.

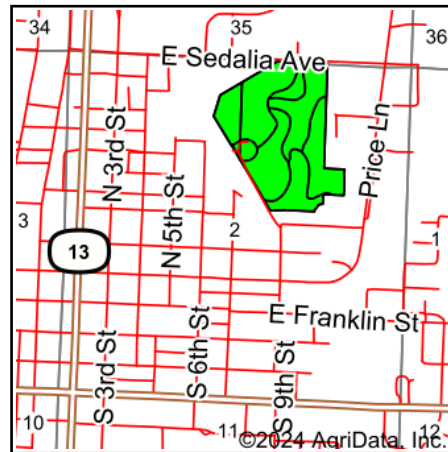

State: **Missouri**
 County: **Henry**
 Location: **2-41N-26W**
 Township: **Clinton**
 Acres: **73.13**
 Date: **4/15/2024**



Area Symbol: MO083, Soil Area Version: 29

Code	Soil Description	Acres	Percent of field	Non-Irr Class Legend	Non-Irr Class *c	Range Production (lbs/acre/yr)	*n NCCPI Overall	*n NCCPI Corn	*n NCCPI Soybeans
40037	Barco loam, 5 to 9 percent slopes, eroded	24.78	33.9%		IVe	0	45	42	27
40053	Deepwater silt loam, 2 to 5 percent slopes	21.86	29.9%		Ile	0	84	84	80
46119	Quarles silt loam, 1 to 3 percent slopes, occasionally flooded	12.51	17.1%		IIIw	0	65	53	65
46005	Verdigris silt loam, 0 to 1 percent slopes, occasionally flooded	8.90	12.2%		IIw	7758	82	82	75
40035	Barco loam, 2 to 5 percent slopes, eroded	2.73	3.7%		IIIe	0	44	41	28
40068	Hartwell silt loam, 1 to 3 percent slopes	2.35	3.2%		Ile	0	67	67	62
Weighted Average					2.89	944.2	*n 65.3	*n 62.1	*n 56.3

*n: The aggregation method is "Weighted Average using all components"

*c: Using Capabilities Class Dominant Condition Aggregation Method

Soils data provided by USDA and NRCS.