

Soils Map

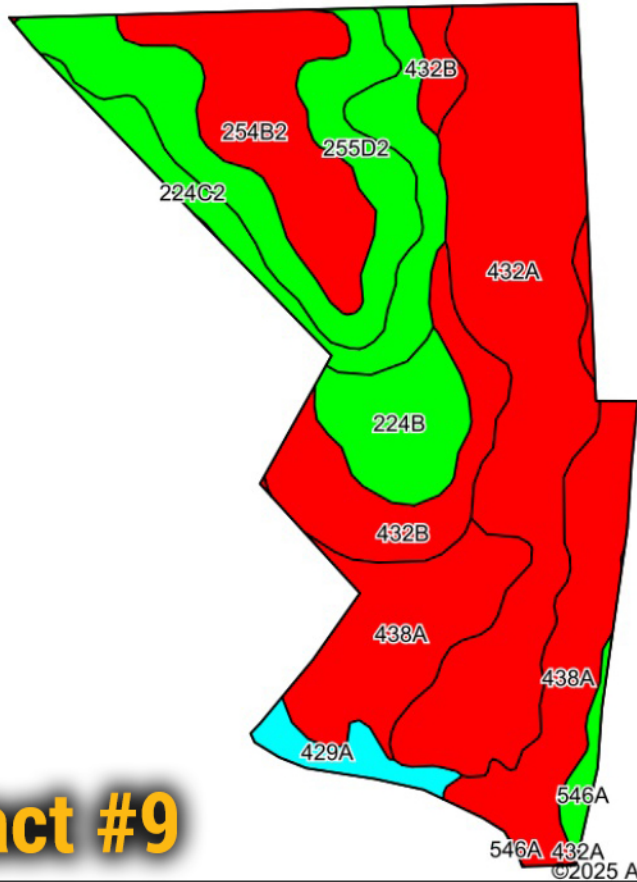

Tract #9

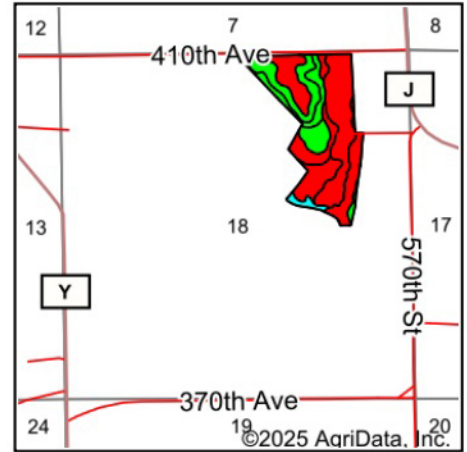

State: **Wisconsin**
 County: **Dunn**
 Location: **18-27N-12W**
 Township: **Red Cedar**
 Acres: **60.74**
 Date: **1/27/2025**

BigIron
 REALTY

Maps Provided By:



Soils data provided by USDA and NRCS.

©2025 AgriData, Inc.

© AgriData, Inc. 2023

www.AgriDataInc.com

Area Symbol: WI1033, Soil Area Version: 22

Code	Soil Description	Acres	Percent of field	Non-Irr Class Legend	Non-Irr Class *c	Corn Bu	*n NCCPI Soybeans
432A	Kevilar sandy loam, 0 to 3 percent slopes	17.45	28.8%		lls	100	53
438A	Hoopston sandy loam, 0 to 3 percent slopes	12.21	20.1%		llw	95	50
255D2	Urne fine sandy loam, 12 to 20 percent slopes, moderately eroded	7.74	12.7%		IVe	65	36
254B2	Norden silt loam, 2 to 6 percent slopes, moderately eroded	6.71	11.0%		lle		55
432B	Kevilar sandy loam, 2 to 6 percent slopes	5.76	9.5%		lls	100	52
224C2	Elevasil sandy loam, 6 to 12 percent slopes, moderately eroded	5.04	8.3%		llle		29
224B	Elevasil sandy loam, 2 to 6 percent slopes	3.72	6.1%		llls		30
429A	Lows loam, 0 to 2 percent slopes, rarely flooded	1.39	2.3%		VIw	105	18
546A	Prissel loamy sand, 0 to 3 percent slopes	0.72	1.2%		llls	65	33
Weighted Average					2.50	68.8	*n 45.9