

# Soils Map

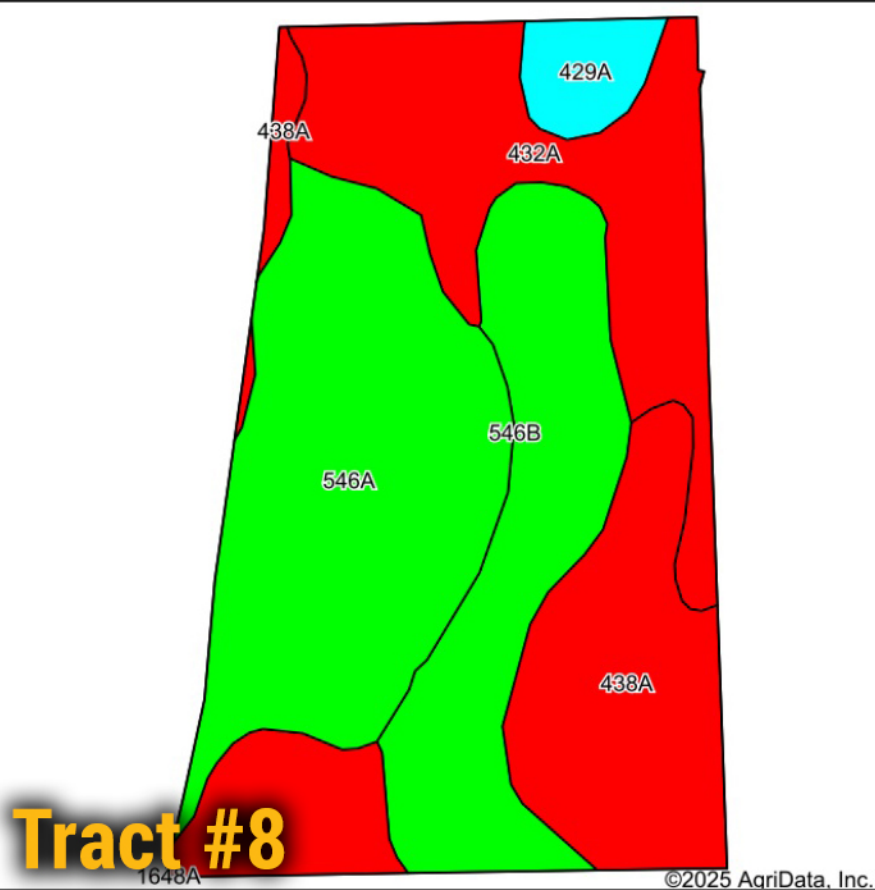

Soils data provided by USDA and NRCS.

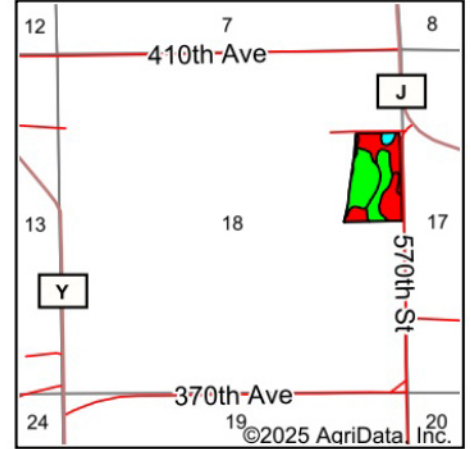

State: **Wisconsin**  
 County: **Dunn**  
 Location: **18-27N-12W**  
 Township: **Red Cedar**  
 Acres: **24.33**  
 Date: **1/27/2025**

**BigIron**  
 REALTY

Maps Provided By:



© AgriData, Inc. 2023

www.AgriDataInc.com



Area Symbol: WI033, Soil Area Version: 22

Code	Soil Description	Acres	Percent of field	Non-Irr Class Legend	Non-Irr Class *c	Corn Bu	*n NCCPI Soybeans	
546A	Prissel loamy sand, 0 to 3 percent slopes	7.58	31.1%		IIIs	65	33	
432A	Kevilar sandy loam, 0 to 3 percent slopes	6.73	27.7%		IIs	100	53	
546B	Prissel loamy sand, 2 to 6 percent slopes	4.79	19.7%		IIIs	65	33	
438A	Hoopeston sandy loam, 0 to 3 percent slopes	4.42	18.2%		IIw	95	50	
429A	Lows loam, 0 to 2 percent slopes, rarely flooded	0.81	3.3%		VIw	105	18	
<b>Weighted Average</b>						<b>2.64</b>	<b>81.5</b>	<b>*n 41.1</b>