

# Soils Map

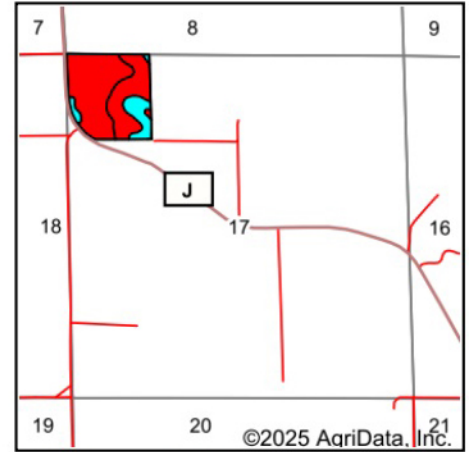
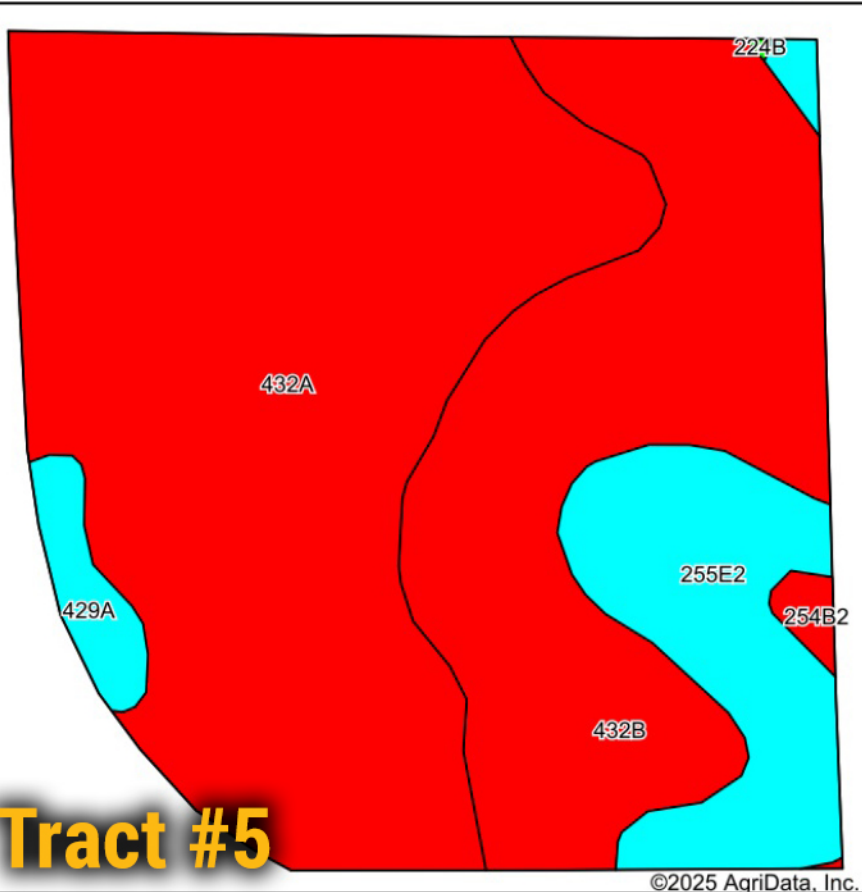

State: **Wisconsin**  
 County: **Dunn**  
 Location: **17-27N-12W**  
 Township: **Red Cedar**  
 Acres: **36.65**  
 Date: **1/27/2025**

**BigIron**  
 REALTY

Maps Provided By:



**Tract #5**

Soils data provided by USDA and NRCS.

©2025 AgriData, Inc.

Area Symbol: WI033, Soil Area Version: 22

Code	Soil Description	Acres	Percent of field	Non-Irr Class Legend	Non-Irr Class *c	Corn Bu	*n NCCPI Soybeans	
432A	Kevilar sandy loam, 0 to 3 percent slopes	19.91	54.3%		Ils	100	53	
432B	Kevilar sandy loam, 2 to 6 percent slopes	11.25	30.7%		Ils	100	52	
255E2	Urne fine sandy loam, 20 to 30 percent slopes, moderately eroded	4.42	12.1%		Vle	55	5	
429A	Lows loam, 0 to 2 percent slopes, rarely flooded	0.81	2.2%		Vlw	105	18	
254B2	Norden silt loam, 2 to 6 percent slopes, moderately eroded	0.26	0.7%		Ile		55	
<b>Weighted Average</b>						<b>2.57</b>	<b>94</b>	<b>*n 46.1</b>