

# Soils Map

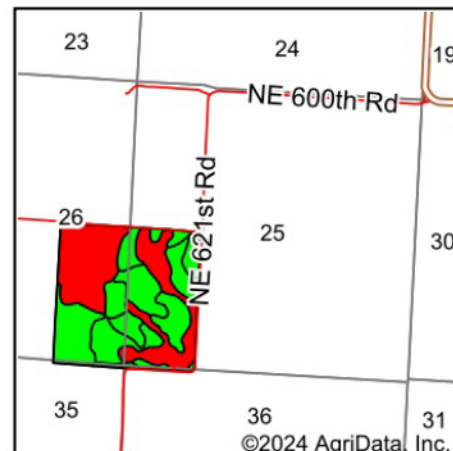
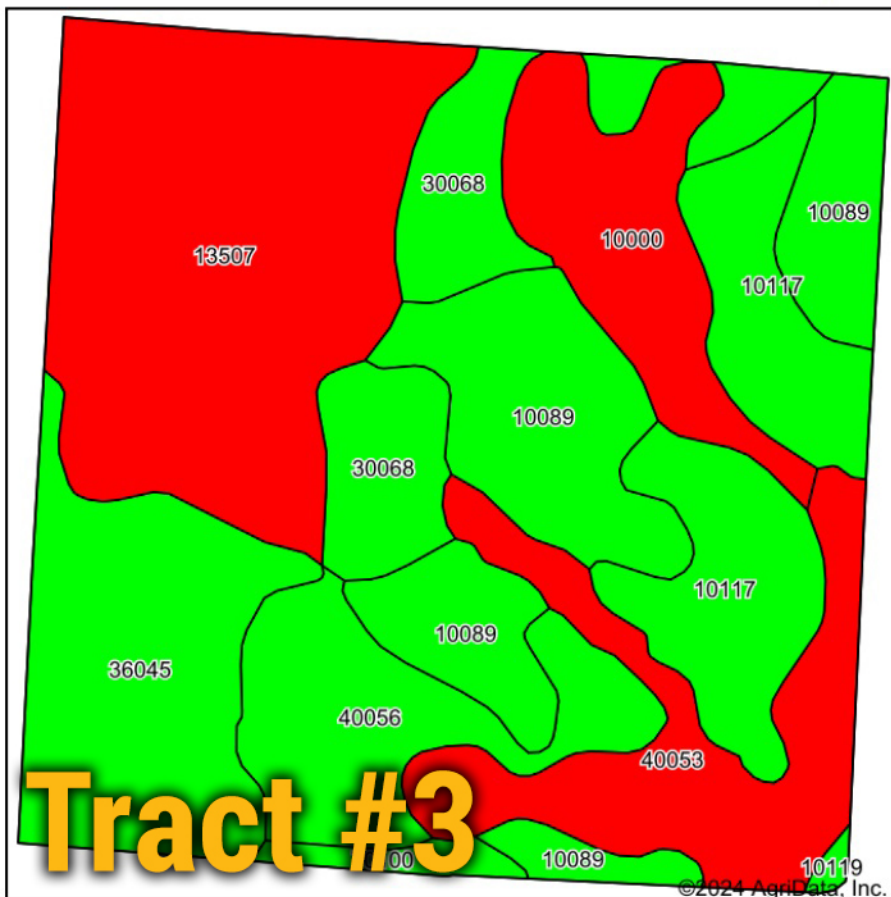

State: **Missouri**  
 County: **Johnson**  
 Location: **26-47N-25W**  
 Township: **Montserrat**  
 Acres: **160**  
 Date: **4/19/2024**

**BigIron**  
 REALTY

Maps Provided By:



Soils data provided by USDA and NRCS.

Area Symbol: MO101, Soil Area Version: 27

Code	Soil Description	Acres	Percent of field	Non-Irr Class Legend	Non-Irr Class *c	*n NCCPI Soybeans
13507	Bremer silty clay loam, 0 to 2 percent slopes, rarely flooded	37.33	23.3%		IIw	59
10089	Mandeville silt loam, 5 to 9 percent slopes	25.09	15.7%		IIIe	54
36045	Wabash silty clay, 0 to 2 percent slopes, frequently flooded	19.54	12.2%		IVw	5
10117	Sampsel silty clay loam, 5 to 9 percent slopes	18.70	11.7%		IIIe	57
40053	Deepwater silt loam, 2 to 5 percent slopes	17.05	10.7%		IIe	80
30068	Gorin silt loam, 5 to 9 percent slopes, eroded	14.21	8.9%		IIIe	54
40056	Deepwater silt loam, 5 to 9 percent slopes, eroded	13.45	8.4%		IIIe	71
10000	Arisburg silt loam, 1 to 5 percent slopes	12.66	7.9%		IIe	67
70100	Bolivar fine sandy loam, 5 to 9 percent slopes, eroded	1.60	1.0%		IIIe	35
10119	Sampsel silty clay loam, 5 to 9 percent slopes, severely eroded	0.37	0.2%		IIIe	44
<b>Weighted Average</b>					<b>2.70</b>	<b>*n 54.5</b>