

Soils Map

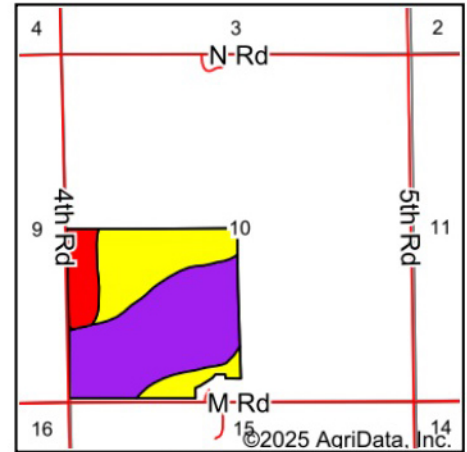
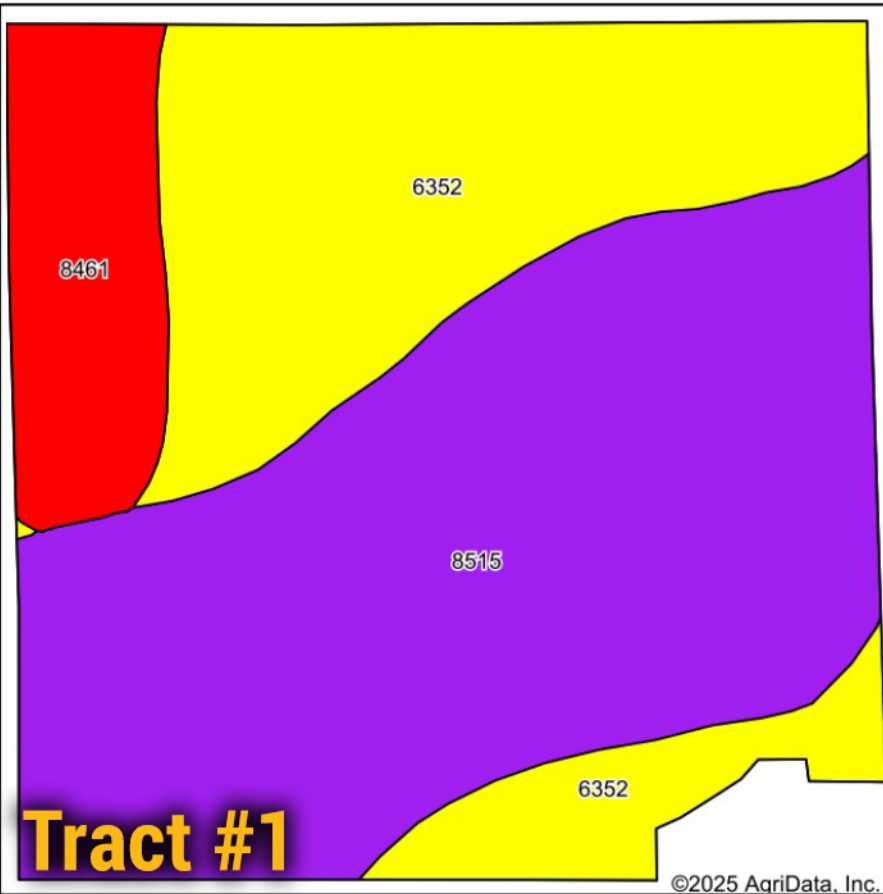

State: **Nebraska**
 County: **Merrick**
 Location: **10-13N-8W**
 Township: **Prairie Creek**
 Acres: **149.26**
 Date: **1/7/2025**

BigIron
REALTY

Maps Provided By:



Soils data provided by USDA and NRCS.

©2025 AgriData, Inc.

© AgriData, Inc. 2023

www.AgriDataInc.com

Area Symbol: NE121, Soil Area Version: 24

Code	Soil Description	Acres	Percent of field	SRPG Legend	Non-Irr Class *c	Irr Class *c	SRPG	Corn Bu	Corn Irrigated Bu	Winter wheat Bu	*n NCCPI Soybeans		
8515	Lockton loam, rarely flooded	82.48	55.3%		IIIw	IIIw	56	48	149	33	35		
6352	Leshara silt loam, occasionally flooded	51.25	34.3%		IIw	IIw	65	74	142	34	64		
8461	Gayville variant silt loam, rarely flooded	15.53	10.4%		IVs	IVs	47	35	82	24	43		
Weighted Average							2.76	2.76	58.2	55.6	139.6	32.4	*n 45.8