

# Soils Map

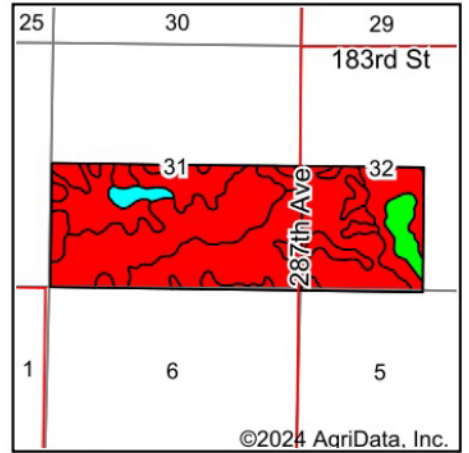

State: **South Dakota**  
 County: **Sully**  
 Location: **31-115N-79W**  
 Township: **West Sully**  
 Acres: **491.16**  
 Date: **11/21/2024**



Maps Provided By:  
  
 CUSTOMIZED ONLINE MAPPING  
 © AgriData, Inc. 2023 www.AgriDataInc.com

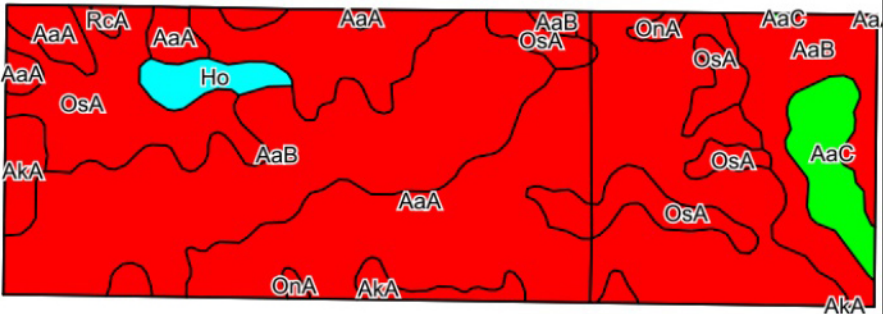

## Tract #1

©2024 AgriData, Inc.

Soils data provided by USDA and NRCS.

Area Symbol: SD119, Soil Area Version: 27									
Code	Soil Description	Acres	Percent of field	Non-Irr Class Legend	Non-Irr Class *c	Productivity Index	Corn Bu	Winter wheat Bu	*n NCCPI Soybeans
AaA	Agar silt loam, 0 to 2 percent slopes	184.63	37.6%		IIc	92			57
AaB	Agar silt loam, 2 to 6 percent slopes	158.96	32.4%		IIe	85			57
OsA	Onita-Hoven silt loams, 0 to 1 percent slopes	98.96	20.1%		IIc	59	60	35	32
AaC	Agar silt loam, 6 to 9 percent slopes	19.20	3.9%		IIIe	73			57
AkA	Agar-Walke silt loams, 0 to 2 percent slopes	15.48	3.2%		IIc	85	46	32	46
Ho	Hoven silt loam, 0 to 1 percent slopes	9.46	1.9%		VIc	15			5
OnA	Mobridge silt loam, 0 to 2 percent slopes	3.02	0.6%		IIc	94			60
RcA	Raber-Cavo loams, 0 to 2 percent slopes	1.45	0.3%		IIc	60			46
<b>Weighted Average</b>					<b>2.12</b>	<b>80.6</b>	<b>13.5</b>	<b>8.1</b>	<b>*n 50.6</b>