

Soils Map

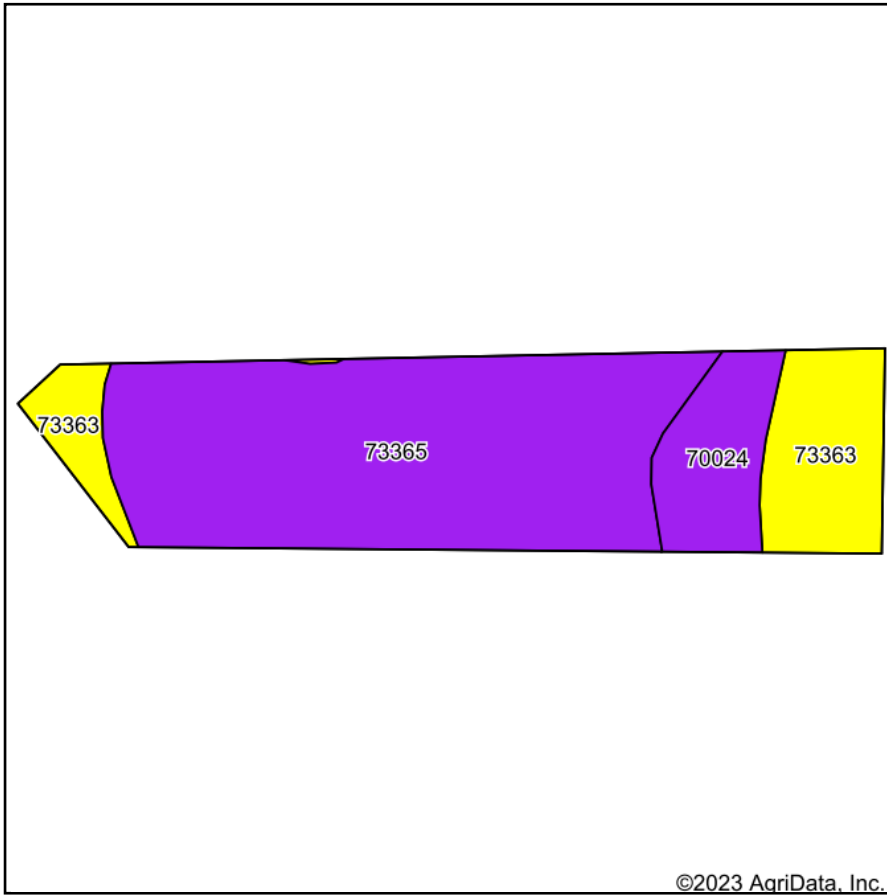

Soils data provided by USDA and NRCS.

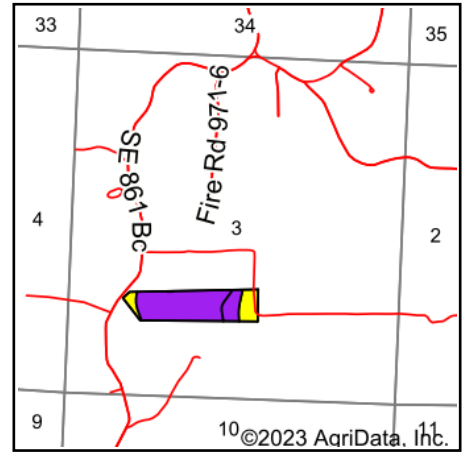

State: **Missouri**
 County: **Benton**
 Location: **3-40N-20W**
 Township: **Cole**
 Acres: **22.09**
 Date: **2/20/2023**



Area Symbol: MO015, Soil Area Version: 27

Code	Soil Description	Acres	Percent of field	Non-Irr Class Legend	Non-Irr Class *c	Tall fescue AUM	*n NCCPI Overall	*n NCCPI Corn	*n NCCPI Small Grains	*n NCCPI Soybeans	*n NCCPI Cotton	
73365	Bardley very gravelly silt loam, 8 to 35 percent slopes, stony	14.88	67.4%		VIIe		34	34	28	20	26	
73363	Bardley gravelly silt loam, 3 to 8 percent slopes	4.50	20.4%		IVe		48	48	48	35	44	
70024	Goss very gravelly silt loam, 15 to 35 percent slopes, very stony	2.71	12.3%		VIe	3	12	11	9	3	8	
Weighted Average						6.27	0.4	*n 34.2	*n 34	*n 29.7	*n 21	*n 27.5

*n: The aggregation method is "Weighted Average using all components"

*c: Using Capabilities Class Dominant Condition Aggregation Method

Soils data provided by USDA and NRCS.