

Soils Map

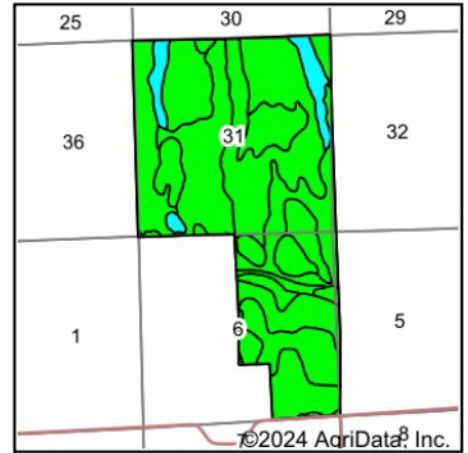
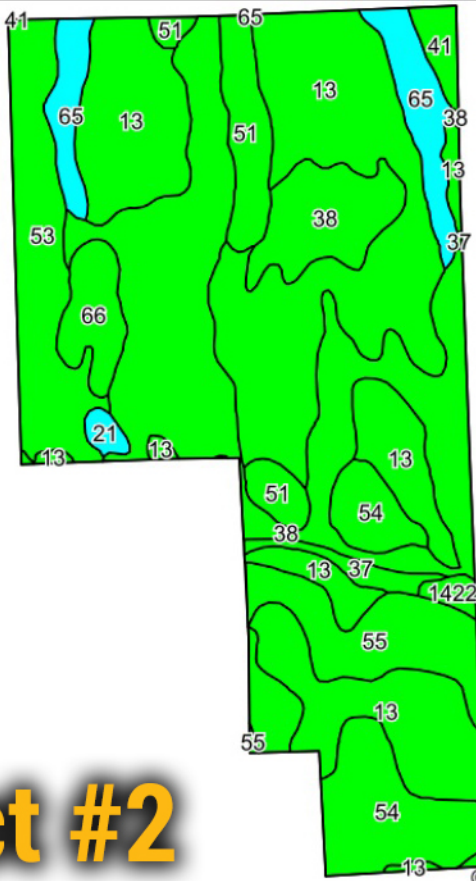

Tract #2

State: **Colorado**
 County: **Cheyenne**
 Location: **31-13S-45W**
 Township: **Cheyenne Wells**
 Acres: **933.28**
 Date: **9/11/2024**

BigIron
REALTY

Maps Provided By:

 CUSTOMIZED ONLINE MAPPING
 © AgriData, Inc. 2023 www.AgriDataInc.com



Soils data provided by USDA and NRCS.

Area Symbol: CO017, Soil Area Version: 25

Code	Soil Description	Acres	Percent of field	Non-Irr Class Legend	Non-Irr Class *c	Irr Class *c	Corn Irrigated Bu	Winter wheat Bu	Winter wheat Irrigated Bu	*n NCCPI Soybeans
13	Fort Collins loam, 0 to 3 percent slopes	347.09	37.3%		IIIe	IIIe				35
38	Satanta loam, 0 to 3 percent slopes	239.06	25.6%		IIIe	Ile	130	22	50	56
54	Wiley complex, 0 to 3 percent slopes, eroded	81.99	8.8%		IVe	Ile	125			24
53	Weld silt loam, 0 to 3 percent slopes	74.19	7.9%		IIIc	Ile				45
55	Wiley complex, 3 to 5 percent slopes, eroded	50.99	5.5%		IVe	IIIe	115			24
65	Colby silt loam, 3 to 9 percent slopes	45.03	4.8%		VIe	VIe				42
51	Vona loamy sand, warm, 3 to 6 percent slopes	42.02	4.5%		IVe	IVe				23
66	Colby silt loam, 1 to 4 percent slopes, eroded	23.51	2.5%		IVe	IVe				39
37	Sampson loam, 0 to 2 percent slopes	9.83	1.1%		IIIc	Ile	140			42
41	Stoneham loam, 0 to 3 percent slopes	9.76	1.0%		IIIe	Ile	100			25
1422	Goshen silt loam, rarely flooded	5.10	0.5%		IIIc	Iw				55
21	Kim loam, 1 to 3 percent slopes, eroded	4.71	0.5%		VIe	Ile	85			22
Weighted Average					3.37	2.75	53.5	5.6	12.8	*n 39.5